

Introduction

Welcome to the Roseacre Primary Academy Project newsletter.

This is the first of a series of newsletters designed to keep the local residents, visitors, staff, parents and pupils of the school informed about the school redevelopment. The newsletter will provide information on the different phases of the project, including changes to access arrangements during the course of the development.

Roseacre Primary Academy



Key Dates

Start on Site:
March 2016

Building Works Complete:
New school academic year September 2016

Architect's Impression of the Scheme



Project Description

The project will provide a new two storey extension to the existing school incorporating 4 new classrooms, storage areas and associated landscaped areas.

Refurbishment of 12 classrooms to be reconfigured to provide 8 new classrooms with associated corridor and storage areas.

Questions & Answers

Q. Will the work affect where children access the school and where parents drop off & pick up?

On Friday 11th March, we are expecting delivery of the site cabins; as such, there will be very limited parking on Stonycroft Avenue. In addition, the small gate on Langfield Avenue will be closed from Friday 11th March until the end of the school year.

Q. What happens to After School / Holiday Club?

After School / Holiday Club will remain as existing and will not be affected by the building works.

Q. Will parking be affected?

Parking on the surrounding roads should not be affected. However, as no pedestrian access is available from the school office to the back of the school, we would advise that all vehicles are aware of the increased number of pedestrians and the potential dangers this can cause.

Q. How will the builders access the school?

All building access will be from the pedestrian gate on Langfield Avenue and this will remain the case for the duration of the building works. A site access for deliveries will be formed on Stonycroft Avenue. All deliveries will be co-ordinated to avoid school peak times i.e no deliveries between 8.30 - 9.30 and 2.30 – 3.30.

For more information on Eric Wright
Construction please visit:
www.ericwright.co.uk

Outline Information

Client: Roseacre Primary Academy
Architect: Cassidy & Ashton
Structural Engineer: Johnston Consulting
M&E: Kingswood
Main Contractor: Eric Wright Special Projects

Site Plan

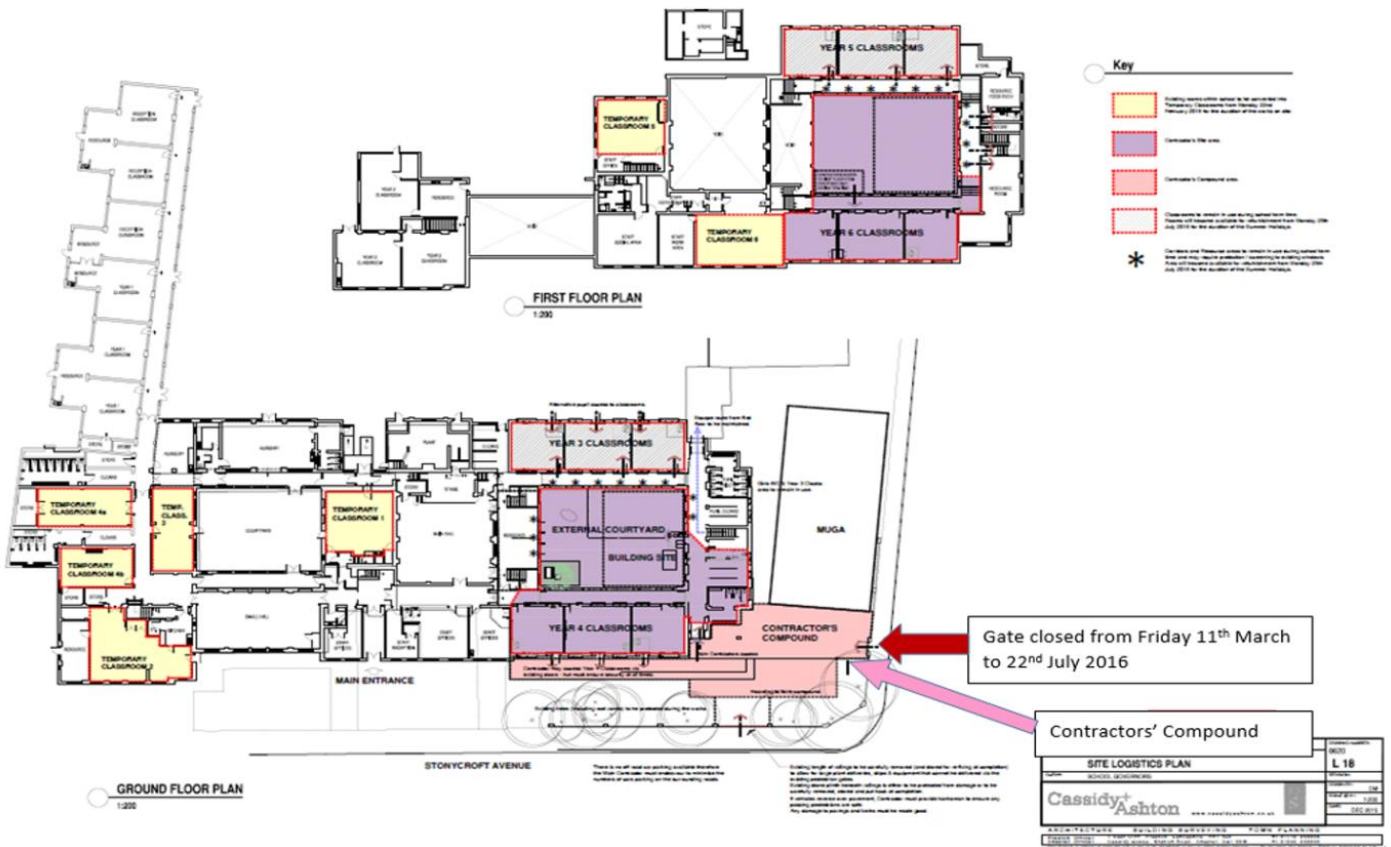

Code of Considerate Practice

The Considerate Constructors Scheme is the national initiative set up by the construction industry to improve its image.

Companies registered with the Scheme are monitored against a Code of Considerate Practice, designed to encourage best practice beyond statutory requirements. As associate members of the Considerate Constructors scheme we are committed to ensuring our sites comply with the following:

✓ **Care about Appearance**

Constructors should ensure sites appear professional and well managed

✓ **Respect the Community**

Constructors should give utmost consideration to their impact on neighbours and the public

✓ **Protect the Environment**

Constructors should protect and enhance the environment

✓ **Secure Everyone's Safety**

Constructors should attain the highest levels of safety performance

✓ **Value their Workforce**

Constructors should provide a supportive and caring working environment



Working in Blackpool

Eric Wright Construction have committed to using local labour and materials where possible while undertaking these works. We will be working with the local jobcentre to advertise any vacancies.

Site Contact Details

Any feedback, suggestions or requests can be directed to our site manager allocated to this project, Mark Green.

T: 07580 590901

E: markg@ericwright.co.uk

If you would like to receive electronic versions of future newsletters please contact us on the email address above.

Please follow us on:

